

News Release July 2019

3D data handling tool 3DTascalX, 3DTascalX / Light "Version 10" released!!

C'set Co., Ltd. (Head office: Shinjuku-ku, Tokyo) announces to release a new version 10.0 of 3D data handling tool "3DTascalX (3DTascal X)" and "3D-Tascal X / Light (3DTascal Light)" on August 5th, 2019. This version supports import of 3D annotation information of CATIA, NX, and Creo, in correspond to 3D independent diagrams that JAMA, JEITA, etc. which are already in active. In addition, we will start selling the interface of Inventor, which is especially requested in overseas markets, as an option. In addition, the price of each interface option will be reconsidered, and only the basic fee will be paid. In terms of functionality, it adds a convenient thumbnail display for easy data management such as Windows Explore. It adds outline package dimensions convenient for estimation and the chamfer dimension necessary for time of processing, and adds the sketch function of the area line close to the material of the part which becomes very convenient. There are a number of other enhancements and new features, so please check the details below. (Some functions are only supported by 3DTascalX)

3DTascalX Major new features / Enhancements

■ Import of 3D annotation information of CATIA, NX, Creo

CATIA, NX, Creo 3D annotation information import: Three interface options of CATIA, NX, and Creo, now allow you to import 3D annotation information. By incorporating not only dimensions and notes but also viewpoints (view information), it is possible to reliably convey the designer's intention. Users who already have interface options can use them by upgrading.

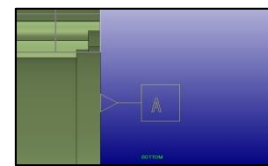
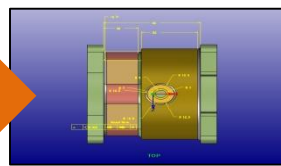
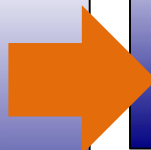
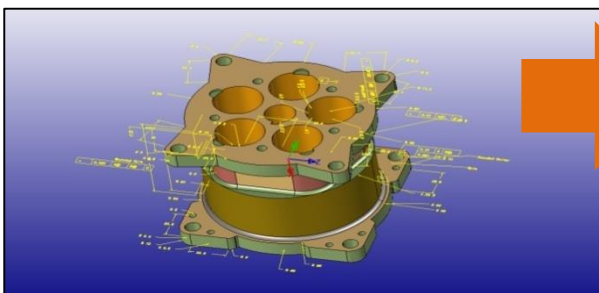
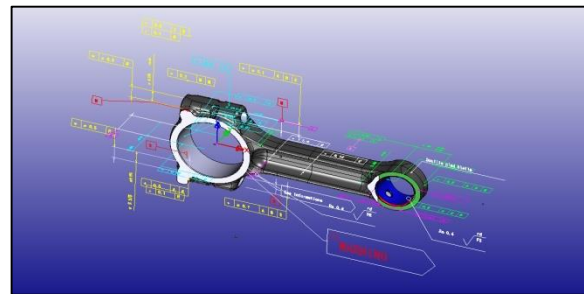
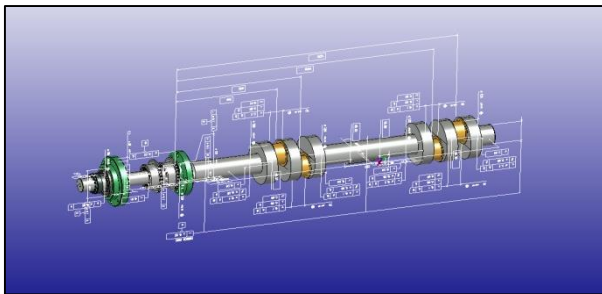

Viewpoint (Viewpoint Information)

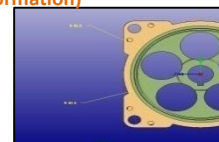

■ Inventor interface option sales start

Start selling the interface option to read the original data format (.ipt, .ipt. *, .iam, .iam. *) of Autodesk "Inventor (V11-V2019)". Please see the last page for pricing.

■ Add points and lines to STEP data output elements

It also corresponds to the point / line element of STEP data that has already been supported in input (import).

■ Thumbnail display function

In an environment where 3D data is increasing, thumbnail displays and notes can be added when 3DX data is saved, in response to many requests that you want to view the image of the contents before opening the data. It is possible to check not only from "Open" menu of 3DTascalX but also on Windows Explore. In order to use it, it is necessary to set the folder

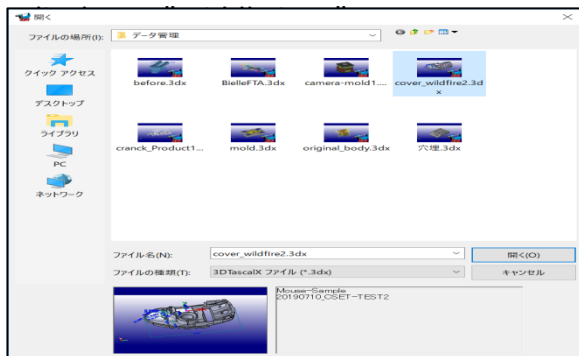

■ Addition of outline package dimension and chamfer dimension

While increasing sales results in the sales department, in response to a request to reduce the time and effort at the time of estimation, we will add a dimension function that can display the maximum external dimensions (XYZ) of parts with one click. This can significantly reduce the number of clicks.

A new element called "Chamfer dimension" is added as a request for placing in the processing process. This makes it possible to measure and instruct C chamfering.

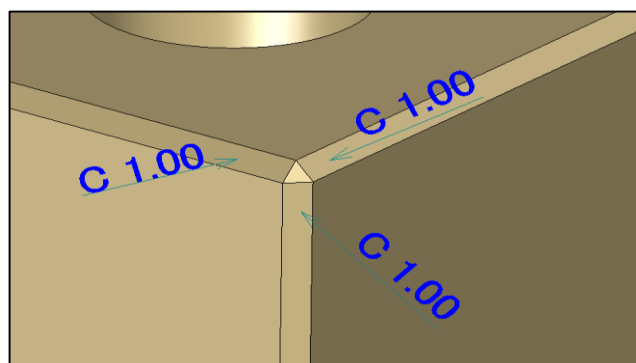
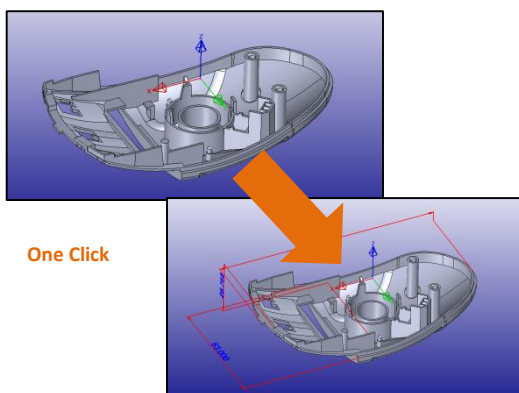

■ Area line sketch function

You can now sketch the bounding box representing the largest part of the part as a straight line. In particular, in the processing process, it becomes a line close to the raw material of the part, which makes it more convenient to create processing standards, measure and remove materials.

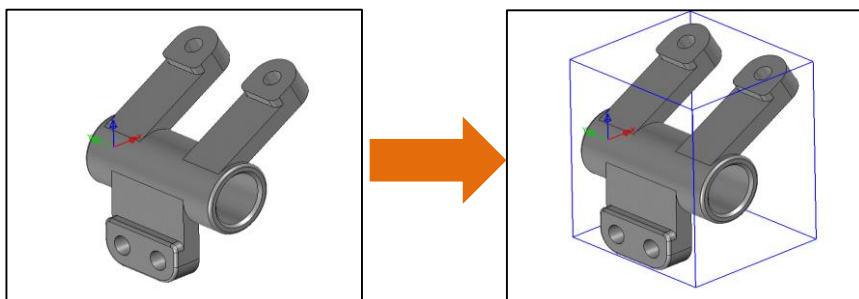

■ Face distraction function in color

It becomes possible to sort based on the color of the surface at the time of the "surface disintegration" function that converts solid data to sheet (surface) data on the screen. Application is possible in the scene etc. which take out only a required surface from solid data while processing instructions by the color of the surface are increasing.

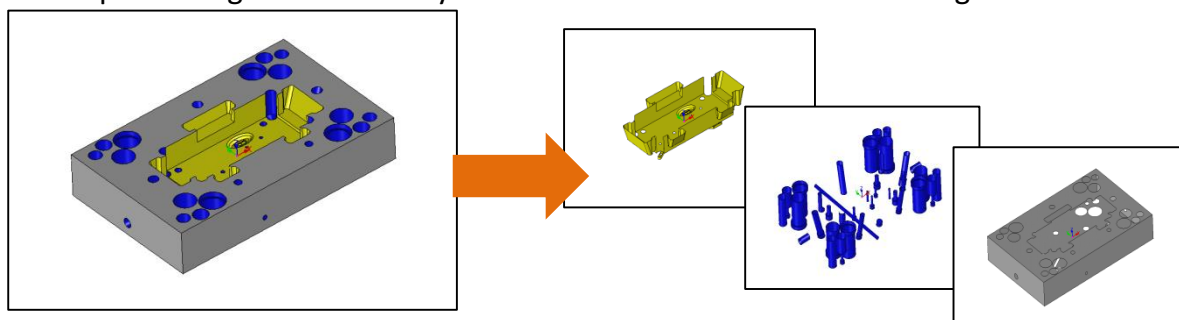

■ Add tolerance table to dimensions on drawing screen (2D)

Expanding 3D data into 2D drawings by adding a tolerance table to the 2D dimension function that can be measured on the drawing screen and clicking the "general tolerance" button, you can automatically enter the target upper and lower tolerances.



■ Parts search function enhancement

The part type (solid sheet assembly) is added to the search condition of "part search" function that can search parts (parts) from assembly (multiple) data.

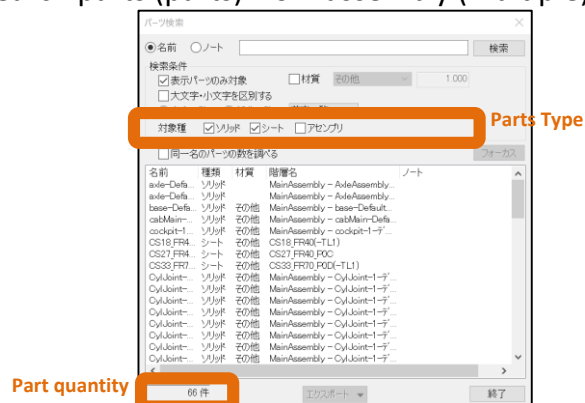

■ D-View Plus range printing function added (3DTascalX only supported)

In the included 2D viewer "D-View Plus", you can print only the specified area by dragging.

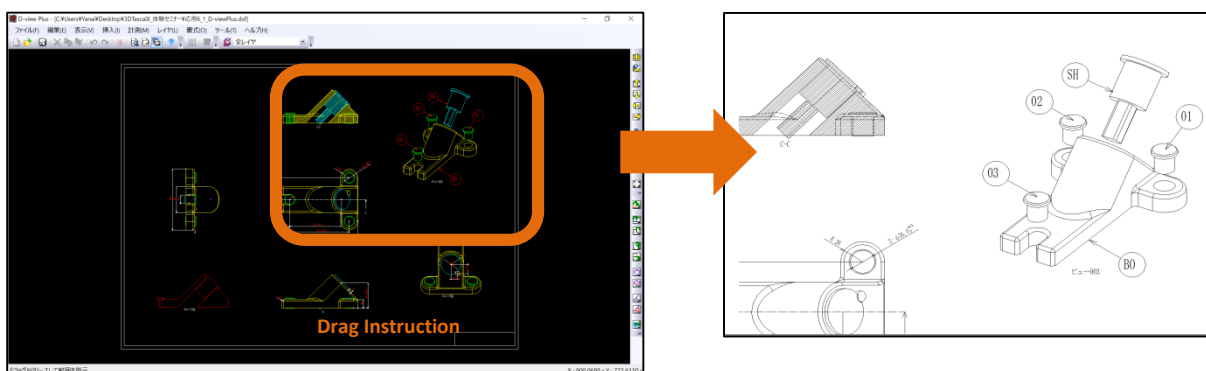

■ Upgrade each interface version

Supported versions of each standard and optional interface have been partially updated.

Parasolid →IN/OUT : ~V31.1 supported

SOLIDWORKS →IN/OUT : 2019 supported (※64bit version only)

CATIAV5 →IN/OUT : 6R2018 supported

NX→IN : 12 supported

Creo →IN : 5.0 supported

■ Others

-It will improve some errors that occurred when entering IGES · STEP · JT · CFIO data.

- If you save 3DX STEP, the problem of increasing the capacity will be improved.
- If you use Bat file in the installation folder, you can initialize toolbars and icons.

-The message changes when the client of floating license tries to start more than the limit .

·Reduced-installation-latency-with-media

- the reference at the output of the created section line becomes the current coordinate.
- IDI data cannot be input.

3DTascalXV10 Product Configuration		
Product Configuration	MSRP	Annual maintenance fee
Base Product configuration		
3DTascalXV10 Node lock license	\$2620	\$550
3DTascalXV10 Floating License	\$2620× QTY + \$730	\$550× QTY
3DTascalX/Light License	\$800	\$780
Interface Option Annual Fee		
CATIA V5(R)Annual Fee	\$620	
CATIA V5(W)Annual Fee	\$1,100	
CATIA V4(RW)Annual Fee	\$420	
NX(R)Annual Fee	\$420	
Creo Parametric (R)Annual Fee	\$420	
CFIO(R) Annual Fee	\$420	
Inventor(R) Annual Fee	\$330	
JT(R)Annual Fee	\$330	
JT&3DPDF(W) Annual Fee	\$330	
ACIS(RW)Annual Fee	\$30	
ALL Interface Option Annual Fee	\$2,730	

※ the inquiry in the maintenance support of 3DTascalX English version is only mail.

※ the-price-list-above-is-excluding-tax.

※ the renewal fee for 3DTascalX / Light and interface option is the annual fee.

※ 3DTascalX body is required to use interface option products

Operating environment:

CPU	:	Intel Core 2 Duo 2.40GHz or higher recommended
RAM	:	64bitOS / At least 4GB
OS	:	Windows 7 Professional Windows 8.1 Professional (Running in Desktop mode) Windows 10 Professional (Running in Desktop mode)
Browser(IE)	:	Internet Explorer 6.0 or higher (3DTascalX/Light Authentication)
Graphics	:	OpenGL Accelerator Compatible Graphic Recommended
Language	:	Japanese/English/Korean

Click here for the latest <http://www.3dtascal.com/>

■Inquiry

C'set Head Office Sales department

〒160-0023

Park west Building 8F, 6-12-1 Nishi Shinjuku, Shinjuku, Tokyo Tel: 03-5323-0830 Fax: 03-5323-0831

Notice: The information contained in this news release is subject to change without notice. The listed product names are trademarks or registered trademarks of C'set Co. Ltd.